

PA-18 Safari Seat Installation Instructions

1. Remove existing seat back. Remove seat bottom springs. Refer to Piper PA-18 Parts Manual.
2. Spread clamps open to accept forward and rear seat bottom tubes - refer to note A on DWG No. 6152.
3. Trim wood/metal as necessary to accept clamps. i.e. under-seat storage box if installed.
4. With bushings on top, insert hardware and tighten finger tight (recommended that all bolts face aft).
5. Insert seat (centered in aircraft) and pin to clamps so that the clamp bushings are on the outboard side of the seat bushings. Check that seat back rest against rear seat cross bar.
6. Tighten bolts to a minimum of 30 inch pounds with seat pinned in place. Check seat operation for full functionality. For aircraft hardware installation practices refer to AC43.13-1B chapter 4, section 3 and 4.
7. Seat must be restrained to rear seat cross bar during flight. Recommend Velcro straps - not included in kit.

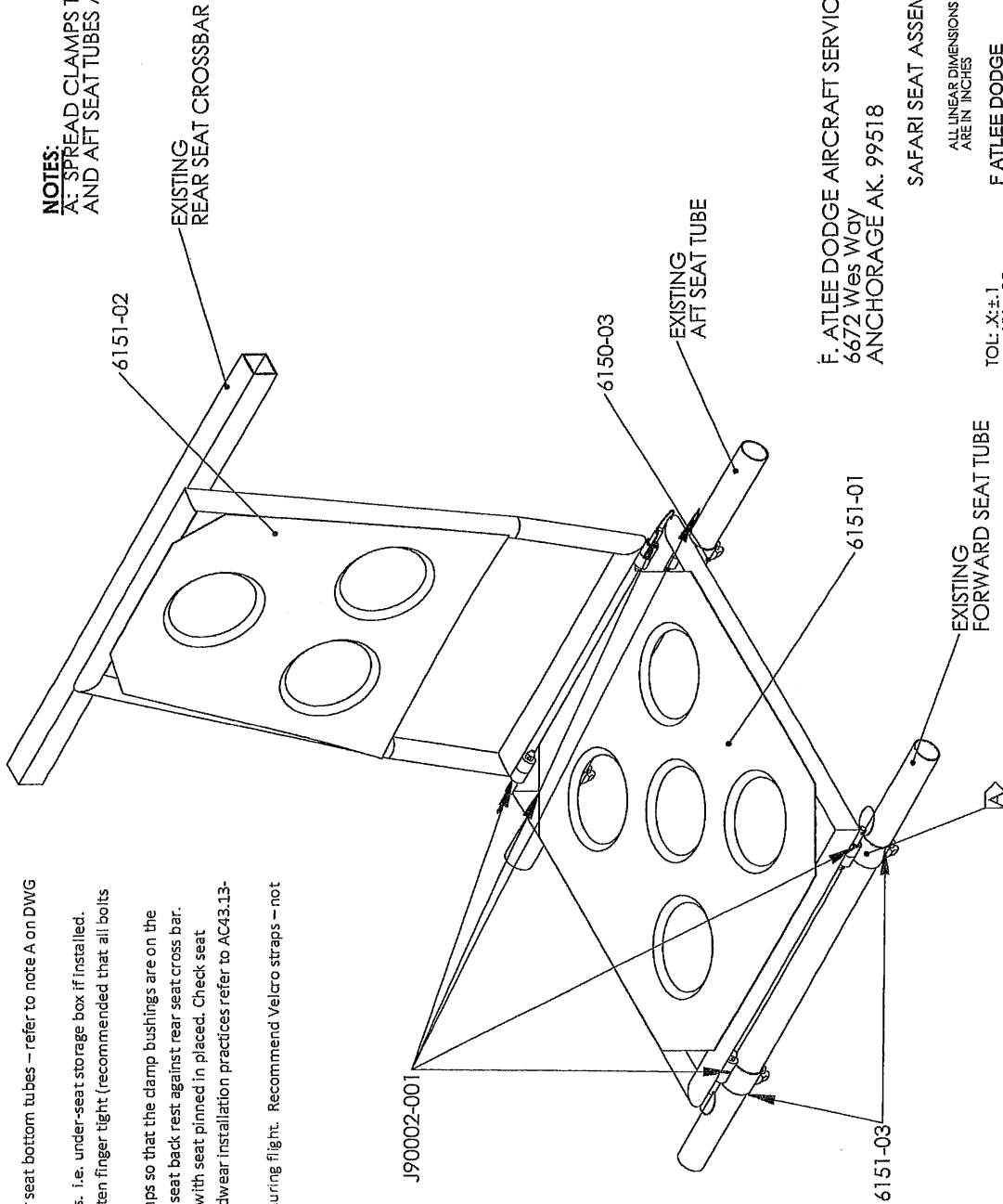

F. ATLEE DODGE AIRCRAFT SERVICES, LLC.
6672 Wes Way
ANCHORAGE AK. 99518



SAFARI SEAT ASSEMBLY

ALL LINEAR DIMENSIONS
ARE IN INCHES

F ATLEE DODGE
Date: 5/27/09
SCALE: 1:4

TOL: X:±.1
XX:±.05
XXX:±.010

DWG: 6152
CHG

APPROV INIT:
SHEET: 1 OF 1

CHG	DATE	INITIAL	DESCRIPTION	GH	PP	BY	CHK
-	1/25/09						

F. Atlee Dodge Aircraft Services, LLC
(907) 344-1755 / Fax (907) 344-6720
Atleedodge@acsalaaska.net

The drawings, specifications, Descriptions, and other critical data attached hereto are property of F. Atlee Dodge Aircraft Services, LLC. No disclosures to others, within the United States of America or abroad, or reproduction of any part of the information supplied is to be released without written authorization from F. Atlee Dodge Aircraft Services, LLC.

F. Atlee Dodge Aircraft Services, LLC

APPROVED FOR RELEASE.

By: *[Signature]* 24 AUG 09