

**Aero Twin, Inc. Main Gear Gravel Deflectors,  
P/N GD6-200  
for  
Cessna Model 206 Equipped with 8.5-10 Tires**

**INSTALLATION INSTRUCTIONS**

Manual GD6B-IM



<b>LOG OF REVISIONS</b>			
REVISIONS		PAGES REVISED AND DESCRIPTION OF REVISIONS	AERO TWIN SIGNATURE
NO.	DATE		
--	4/1/92	Original Issue	
A	7/4/97	Revised per ECO AT-38, Format revised, All pages revised.	Michael Lovett
B	02/14/08	Revised per ECO AT-132, revised all pages	Jason Kepler
C	11/12/12	Revised pages 2-4 per ECO AT-150.	

## Aero Twin, Inc. Main Gear Gravel Deflectors P/N GD6-200

### 1.0 Installation

**NOTE: This kit is intended for installation on aircraft equipped with 8.50-10 tires (approved wheel adapters and STC required!) For 206's with standard wheels and tires, use Aero Twin Gravel Deflector Kit No. GD6-100, (STC No. SA4614NM).**

1. Remove left main wheel assembly per FAA approved maintenance manual.
2. Remove nuts from axle bolts. Replace the existing bolts and outboard washers with the new bolts and washers supplied in this kit, per Drawing GD26-I, Sheet 1. Note that the new bolts are longer than the originals. Removal and replacement of bolts in rotation (as opposed to complete removal of axle and brake caliper) will assure that axle shims will not be misaligned during reassembly.
3. Install the left gravel deflector as shown on Drawing GD26-I, Sheet 1.
4. Install new NAS1149 washers and nuts supplied with kit; note that up to three washers may be required for proper thread exposure; torque nuts as specified in the FAA approved maintenance manual.
5. Reinstall the wheel assembly following procedures described in the FAA approved maintenance manual.
6. Repeat steps 1-5 to install right gravel deflector.
7. Fit the rubber tire scrapers on the top surface of the installed gravel deflector frames, with the circular cut-out butted against the tire's tread. Match-drill the fastener holes upward through the frame and then through the fitted rubber scraper. Bore out the holes in the rubber scraper using a 0.25 in. drill bit.
8. Install the tire scrapers using the supplied hardware.
9. Trim excess material from edge of scrapers, flush with outer edge of frame.
10. Attach the "NO STEP" placard on the top side of the rubber tire scraper as shown on drawing GD26-I, Sheet 2.
11. Execute FAA form 337 in duplicate, stating that this gravel deflector kit was installed in accordance with this STC. The total change in airplane empty weight and balance is:  
12.0 lb. at fuselage station 60.5

## 2.0 Parts List

Qty	Part Number	Item Description
1	206GDB-L	Left Gravel Deflector Assembly
1	206GDB-R	Right Gravel Deflector Assembly
2	GD6B-112	Rubber Tire Scraper
12	NAS1149F0663P	Washer
12	NAS1149F0563P	Washer
4	MS20002C6	Washer
4	MS20002C5	Washer
4	NAS146-48 or MS20006-37	Bolt
4	NAS145-45 or MS20005-36	Bolt
4	MS21042L6	Nut
4	MS21042L5	Nut
14	MS21042L3	Nut
14	A3235-028-935 or FW235-28	Washer
4	MS24694S70	Screw
10	MS24694S68	Screw
14	NAS1149F0332P	Washer
2	GD-NSP	Placard
4	MS20470A4-9	Rivet
4	NAS1149FN432P	Washer

-----END-----

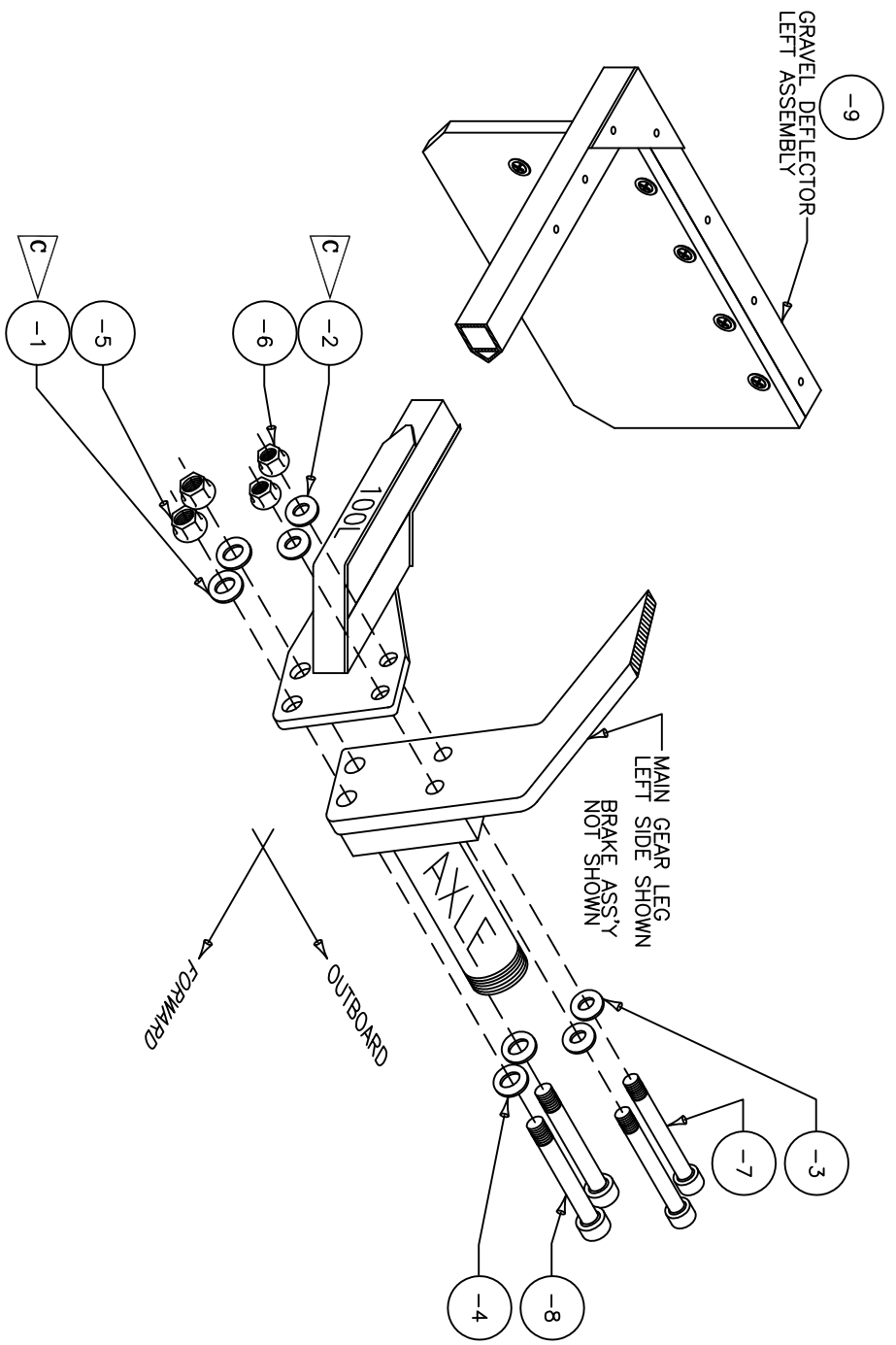

NOTE:

- A** REMOVE WHEEL ASSEMBLY PER FAA APPROVED MAINTENANCE MANUAL.
- B** INSTALL GRAVEL DEFLECTOR AS SHOWN; USE UP TO (3) WASHERS ON EACH BOLT AS REQUIRED FOR CORRECT THREAD EXPOSURE.
- C** REINSTALL NUTS AND TORQUE PER FAA APPROVED MAINTENANCE MANUAL.
- D** INSTALL WHEEL ASSEMBLY PER FAA APPROVED MAINTENANCE MANUAL.

\* QUANTITY AS REQUIRED: TWELVE(12) EACH SUPPLIED WITH KIT.

ITEM	QTY	PART NO.	DESCRIPTION	MATERIAL	DIMENSION	SPECIFICATION
-1	*	MS1149F0663P	WASHER			
-2	*	MS1149F0663P	WASHER			
-3	4	MS2000205	WASHER			
-4	4	MS2000206	WASHER			
-5	4	MS2104216	NUT			
-6	4	MS2104215	NUT			
-7	4	MS148-45	BOLT			
-8	4	MS148-48	BOLT			
-9	TR. TL	Z06G09-L(R)	GRAVEL DEFLECTOR ASSEMBLY			

B	ECO AT-150	11/12/12	GMW
A	ECO AT-132	02-14-09	BAS
	ORIGINATED PER ECO AT-38	07-04-97	DRG
LET	REVISION	DATE	INIT

**AERO TWIN, INC.**  
2403 MERRILL FIELD DRIVE ANCHORAGE AK 99501

CESSNA 206

## GRAVEL DEFLECTOR INSTALLATION

TO DIMENSIONS UNLESS OTHERWISE NOTED

X.X = X.XX = X.XXX = X.X" = ± 0.1 ± 0.05 ± 0.01 ± 3"

DWN: DRG DATE: 06-27-97 SCALE: NTS

APP'D: M. LOVETT DWG: **GD26-1**

SHEET: 1 OF 2

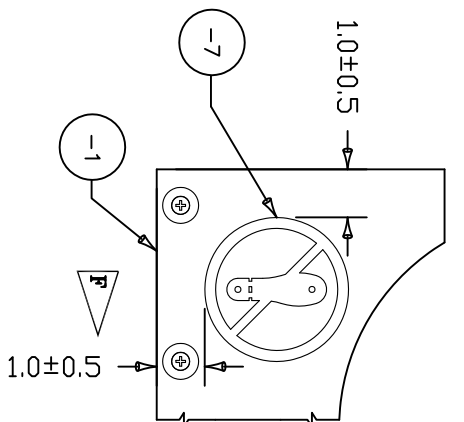
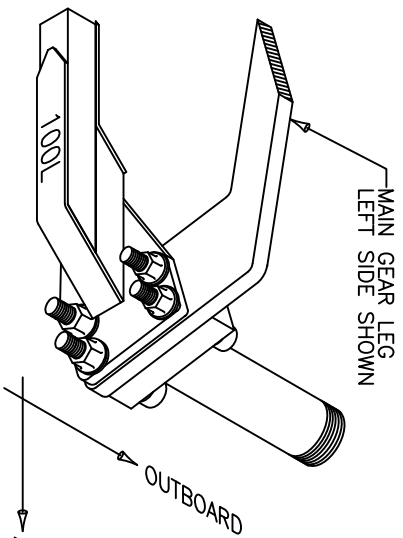
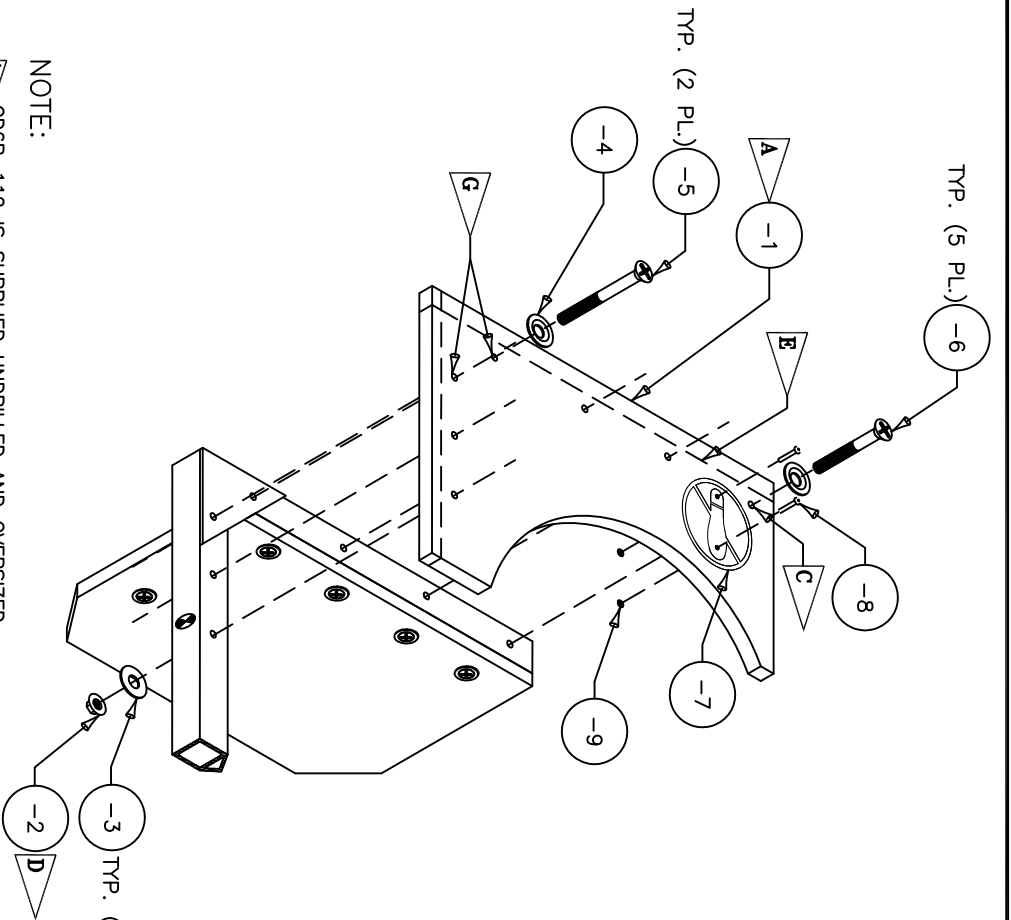

- NOTE:
- ▶ GD6B-112 IS SUPPLIED UNDRILLED AND OVERSIZED.
  - ▶ INSTALL SCRAPER ONLY AFTER DEFLECTOR FRAME IS INSTALLED ON AIRCRAFT AND WHEEL/TIRE ASSEMBLY IN PLACE ON AXLE.
  - ▶ FIT SCRAPER ON TOP SURFACE OF FRAME. SNUG AGAINST TIRE. MATCH DRILL 3/16 HOLES THROUGH SCRAPER AT (7) PLACES.
  - ▶ BORE OUT HOLES THROUGH SCRAPER USING 1/4 DRILL.
  - ▶ INSTALL SCRAPER USING LISTED HARDWARE. TIGHTEN ITEM -2 UNTIL OUTSIDE EDGE OF ITEM -4 CONTACTS SURFACE OF ITEM -1. MAINTAIN MINIMUM OF 1.5-THREAD EXPOSURE THROUGH LOCKING FEATURE OF ITEM -2.
  - ▶ TRIM EXCESS MATERIAL FROM SCRAPER. FLUSH WITH OUTSIDE EDGE OF FRAME.
  - ▶ AFTER TRIMMING SCRAPER, POSITION ITEM -7 AS SHOWN AND MATCH DRILL SCRAPER TO ACCEPT ITEM -8 RIVETS AND RE-PLACED WITH A SELF-ADHESIVE NO STEP PLACARD (AVAILABLE FROM WWW.AIRCRAFTSPRUCE.COM AS P/N 09-34500)
  - ▶ ATTACH ITEM -9 TO TOP OF SCRAPER USING ITEMS -8 AND -9. OPTIONALLY, ITEMS -7, -8 AND -9 MAY BE OMITTED AND RE-PLACED WITH A SELF-ADHESIVE NO STEP PLACARD (AVAILABLE FROM WWW.AIRCRAFTSPRUCE.COM AS P/N 09-34500)
  - ▶ (2) MS24694S70 ARE INSTALLED IN THE CORNER THROUGH THE GUSSET THROUGH THE PLATE.

WHEEL ASSEMBLY NOT SHOWN

FORWARD

ITEM	QTY	PART NO.	DESCRIPTION	MATERIAL	DIMENSION	SPECIFICATION
-1	2	GD6B-112	TIRE SCRAPER			GD26-P. 3 OF 3
-2	14	MS21042L3	NUT			
-3	14	MS1149F0332P	WASHER			
-4	14	A3235-028-935	WASHER			ALT P/N: FW235-28
-5	4	MS24694S70	SCREW			
-6	2	MS24694S88	SCREW			
-7	2	GD-NSP	PLACARD			GD-NSP. 1 OF 1
-8	4	MS2047044-9	RIVET			
-9	4	MS1149FN432P	WASHER			

B	ECO AT-150	11/12/12	GBW
A	ECO AT-132	02-14-09	BAS
LET	ISSUED PER ECO AT-38	07-04-97	DRG
REVISION	DATE	INIT	

**AERO TWIN, INC.**  
2403 MERRILL FIELD DRIVE ANCHORAGE AK 99501  
CESSNA 206

TIRE SCRAPER INSTALLATION			
X.X	X.XX	X.XXX	X.X"
± 0.1	± 0.05	± 0.01	± 3"

DWN: DRG DATE: 06-27-97 I SCALE: NTS  
APP'D: M. LOVETT DWG: GD26-1  
SHEET: 2 OF 2